

dumaplast®

EXTRUDED PRODUCTS



SELF-ADHESIVE



CAN BE GLUED DIRECTLY
TO OLD TILES



UV-RESISTANT



WATER RESISTANT



STRONG

*Quick and easy
tiling* thanks to
self-adhesive backside

 **dumawall®**
WATERPROOF WALL TILES



Quick Fix



dumawall®

WATERPROOF WALL TILES

Quick Fix

Do it yourself and quickly!

Dumawall Quickfix is a tile you can easily install on your own, because of its adhesive back. You do not need special tools and you will have a completely new waterproof wall **in only 3 steps!**

- 1 Clean and degrease the base surface.**
- 2 Remove protective film from adhesive layer.**
- 3 And start working!**

It is **easy and fast**, it's the **Dumawall QuickFix**.



Aluminium accessories

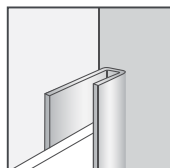

WH PROF
FINISHING TRIM U

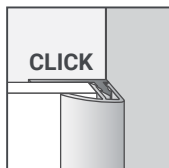

W02
CLICK FINISHING
TRIM

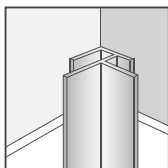

W03
UNIVERSAL CORNER

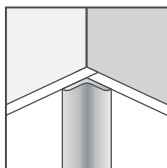

W04
INSIDE CORNER

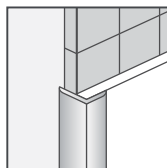

W05
L-TRIM OUTSIDE
CORNER

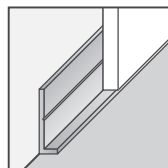

W06
START TRIM

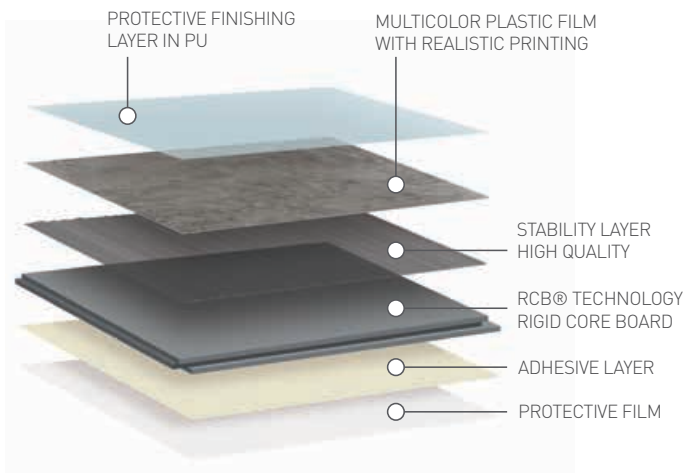

UNIQUE RCB TECHNOLOGY



Our slabs are made with the revolutionary RCB® technology. RCB® is the abbreviation of Rigid Core Board, slabs with a hard core. This unique and patented technology offers our slabs stability, proper sealing and safety. The ideal base for slabs that you will enjoy for a long time.



953 PARIS



956 LYON

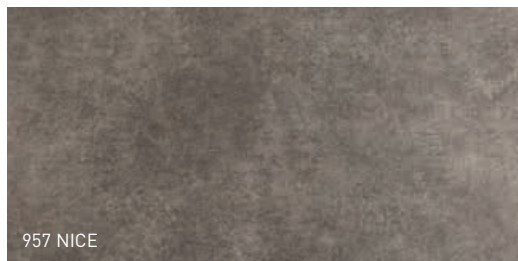

957 NICE

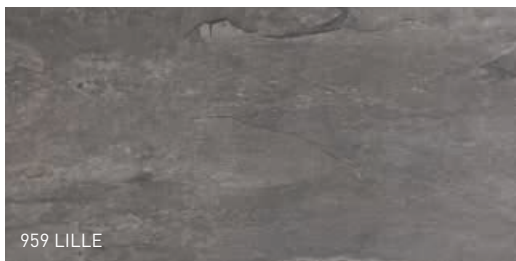

959 LILLE

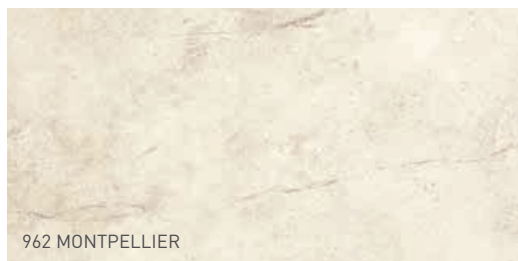

962 MONTPELLIER



965 ARLES



964 CARCASSONNE



961 POITIERS





Although we pay special attention to the information mentioned or published, it may be incorrect or incomplete.
All details are mentioned in good faith and to reflect the current state of our knowledge.
That's why it may not be used against us.



5 411090 035479

dumaplast[®]
EXTRUDED PRODUCTS

Vliegplein 41 - B-9990 Maldegem - Belgium
Tel. +32 50 72 90 11 | Fax +32 50 71 72 28
www.dumaplast.com | info@dumaplast.be